



Licensing Panel

Members of the **Licensing Panel** of **Gravesham Borough Council** are summoned to attend a meeting to be held Virtually - www.youtube.com/graveshamtv on **Monday, 9 November 2020 at 10.00 am** when the business specified in the following agenda is proposed to be transacted. Details on how Members can attend the meeting will be sent separately.

In response to COVID-19, the Government has legislated to permit remote attendance by Elected Members at formal meetings. This is conditional on other Elected Members and the public being able to hear those participating in the meeting. This meeting will be streamed live and can be watched via Gravesham Borough Council's YouTube Channel:-

www.youtube.com/graveshamtv

S Walsh
Service Manager (Communities)

Agenda

Part A

Items likely to be considered in Public

1. Apologies for absence
2. To declare any interest Members may have in the applications being considered. When declaring an interest a Member must state what their interest is.
3. Consideration of an Application for a Premises Licence for Saviany, 60-61 New Road, Gravesend Kent DA11 0AD - 20/01333/LAPL01 (Pages 3 - 26)

Part B

Items likely to be considered in private

None.

Members

Cllr Steve Thompson (Chair)

Councillors: Tony Rana
 Frank Wardle

Substitutes: To be notified

Classification: Public

Key Decision: Yes

Gravesham Borough Council

Report to: Licensing Panel

Date: 9 November 2020

Reporting officer: Mandy Francis - Licensing Manager

Subject: Consideration of Application for a Premises Licence for 60-61 New Road, Gravesend, Kent DA11 0AD

Purpose and summary of report:

To assist Members to determine an application, to which representations have been received, for the grant of a new premises licence under the Licensing Act 2003 - Application reference 20/01333/LAPL01

Recommendations:

1. Members are requested to determine the application on its merits.

1. Introductions

- 1.1 The Licensing Panel is asked to determine an application for a new premises licence under the Licensing Act 2003 in respect of the premises known Saviany at 60-61 New Road, Gravesend, Kent DA11 0AD.
- 1.2 The Licensing Act 2003 (the 2003 Act) requires the Council (as licensing authority) to carry out its various functions so as to promote the following four licensing objectives:
 - the prevention of crime and disorder
 - the protection of public safety
 - the prevention of public nuisance
 - the protection of children from harm
- 1.3 The 2003 Act requires the council to publish a 'Statement of Licensing Policy' that sets out the policies the council will generally apply to promote the licensing objectives when making decisions on applications made under the Act. The council adopted its Statement of Licensing Policy on 20 December 2004. As required by section 5 of the Act, this policy has been subject to periodic revisions with the current policy set to expire on 15 April 2024. The Policy will be available at the meeting for reference purposes.
- 1.4 Under the 2003 Act, licensing authorities must, in carrying out their functions, have regard to guidance issued by the Secretary of State under section 182. The Guidance cannot anticipate every possible scenario or set of circumstances that

may arise. Provided that the licensing authority has properly understood and considered the Guidance, it may depart from it when it has reason to do so. However, as the licensing authority is under a duty to have regard to the Guidance, it will need to give full reasons for any departure from it. This would be a key consideration for the courts should departure from the Guidance result in a determination which gives rise to an appeal or judicial review. The Guidance will be available at the meeting for reference purposes.

- 1.5 A copy of the council's approved procedure for hearings of the Panel in relation to an application, along with a copy of the Hearing regulations has been circulated to all parties prior to the meeting.
- 1.6 The Licensing Authority must, under the Act, refer any application for hearing to the Licensing Panel where relevant representations are made by a responsible authority or an interested party.
- 1.7 The Panel is reminded that the Human Rights Act guarantees the right to a fair hearing for all parties in the determination of their civil rights. The act also provides for the protection of property which may include licences in existence, and the protection of private and family life

2. Background

- 2.1 This is an application for a new premises licence.

3. The Application

- 3.1 On 17 November the application was deemed complete. The application was submitted by Mr Alexandru Savescu for a New Premises Licence under section 17 of the Licensing Act 2003.
 - 3.1.1 The application is for: Off sales of alcohol Monday to Saturday 10.00 to 20.00 hrs and Sunday 10.00 to 16.00 hrs.
- 3.2 Part M of the statutory application form asks applicants to describe the steps they intend to take to promote the four licensing objectives. Where an application has been properly made and no responsible authority or other person has made a relevant representation, or where representations are made and subsequently withdrawn, these proposals are 'converted' in the form of clear and enforceable licence conditions which, together with the Mandatory conditions, make up part of the Premises Licence.
- 3.3 A copy of the application is shown as Appendix 2. A copy of the plan is shown at Appendix 3.
- 3.4 The application has been correctly advertised in the local press and notices displayed on the premises for the required timescale.

4. Representations

- 4.1 At any stage during the 28 day consultation period a responsible authority, a Councillor or an interested party, may make representations provided that the grounds are relevant to the licensing objections and are not deemed to be vexatious, frivolous or repetitive.

4.2 On 13 October 2020, we received a representation from a member of public. The detail of this objection can be found as Appendix 4.

4.3 No representations have been received from the Responsible Authorities.

5. Determining the Application

5.1 The Panel must, when reaching a decision on the outcome of the application, take into account the licensing objectives. Having had proper regard to the matters above the Panel may:

5.1.1 Grant the licence application as applied for;

5.1.2 Modify the conditions of the licence or add any new conditions; or

5.1.3 Reject the whole or part of the application

6. Matters to be taken into consideration

6.1 Local Statement of Licensing Policy considerations

It is considered that certain sections of the policy are relevant to this application.

Section 80 talks about how the absence of a Cumulative Impact Policy, doesn't prevent a responsible authority or interested party from making representations on any application on the grounds that the premises may give rise to, or otherwise contribute to cumulative impact.

6.2 Secretary of State Guidance considerations

It is considered that certain matters have a bearing upon the application and these are summarised below:

9.37 As a matter of practice, licensing authorities should seek to focus the hearing on the steps considered appropriate to promote the particular licensing objective or objectives that have given rise to the specific representation and avoid straying into undisputed areas.

9.38 In determining the application with a view to promoting the licensing objectives in the overall interests of the local community, the licensing authority must give appropriate weight to:

- *The steps that are appropriate to promote the licensing objective;*
- *The representations present by all parties;*
- *The Section 182 guidance*
- *It's own statement of licensing policy*

6.3 Human Rights

The Panel is reminded that the Human Rights Act 1998 guarantees the right to a fair hearing for all parties in the determination of their civil rights. The Act also provides for the protection of property, which may include licences in existence and the protection of private and family life.

7. BACKGROUND PAPERS

- 7.1 Anyone wishing to inspect background papers should, in the first place, be directed to Committee & Electoral Services who will make the necessary arrangements.

IMPLICATIONS	APPENDIX 1
Legal	<p>The Panel have to decide the outcome of the application taking into account the four licensing objectives.</p> <p>In accordance with the provisions of the Act, if a licensing authority rejects in whole or in part, an application to grant a premises licence the applicant may appeal against the decision, to a Magistrates' court within 21 days of being notified of the decision.</p> <p>Similarly, where a person who made relevant representations in relation to the application contends that the licence ought not to have been granted or that different or additional conditions should have been imposed on the licence; they may appeal against the decision, to a Magistrates' court within 21 days of being notified of the decision.</p>
Finance and Value for Money	None unless there is an appeal about the Panel decision to Magistrates' Court which proves to be successful and which could therefore result in costs being awarded against the Council.
Risk Assessment	Departure from the Guidance and Policy could lead to an increased risk of appeal. Similarly if any decision made is not evidence based and proportionate
Data Protection Impact Assessment	<p><i>A data protection impact assessment (DPIA) should be carried out at the start of any major project involving the use of personal data or if you are making a significant change to an existing process.</i></p> <p>a. Does the project/change being recommended through this paper involve the processing of personal data or special category data or criminal offence data? A definition of each type of data can be found on the Information Commissioner's Office website via the above links.</p> <p>b. If yes to question a, have you completed and attached a DPIA including Data Protection Officer advice?</p> <p>c. If no to question b, please seek advice from your nominated DPIA assessor or the Information Governance Team at gdpr@medway.gov.uk.</p>
Equality Impact Assessment	<p>a. Does the decision being made or recommended through this paper have potential to cause adverse impact or discriminate against different groups in the community? If yes, please explain answer. No</p> <p>b. Does the decision being made or recommended through this paper make a positive contribution to promoting equality? If yes, please explain answer. No</p> <p><i>In submitting this report, the Chief Officer doing so is confirming that they have given due regard to the equality impacts of the decision being considered, as noted in the table above</i></p>
Corporate Plan	There are direct links to Corporate Objective 1 - People. Enforce High regulatory standards: put customer and employee safety first by ensuring commercial businesses and licence holders are fully compliant with expected legislative standards

Climate Change	N/a
Crime and Disorder	There are obvious links to community safety and the perception of crime and disorder if licensed premises are not run and managed properly or adequately enforced.
Digital and website implications	Basic public notices are displayed during the consultation period.
Safeguarding children and vulnerable adults	The Licensing Act 2003 required premises licence holders to promote the licensing objective to protect children from harm. Licensing Authorities must play their part in taking the required action against those that don't appear to be upholding this objective.

- g) a person who is registered under Part 2 of the Care Standards Act 2000 (c14) in respect of an independent hospital in Wales please complete section (B)
- ga) a person who is registered under Chapter 2 of Part 1 of the Health and Social Care Act 2008 (within the meaning of that Part) in an independent hospital in England please complete section (B)
- h) the chief officer of police of a police force in England and Wales please complete section (B)

* If you are applying as a person described in (a) or (b) please confirm (by ticking yes to one box below):

I am carrying on or proposing to carry on a business which involves the use of the premises for licensable activities; or

I am making the application pursuant to a
 statutory function or
 a function discharged by virtue of Her Majesty's prerogative

(A) INDIVIDUAL APPLICANTS (fill in as applicable)

Mr.	Other Title (for example, Rev)	
Surname SAVESCU	First names ALEXANDRU	
Date of birth 14/10/1986	I am 18 years old or over	YES
Nationality ROMANIAN		
Current residential address if different from premises address		
Post town		Postcode
Daytime contact telephone number		
E-mail address (optional)		
Where applicable (if demonstrating a right to work via the Home Office online right to work checking service), the 9-digit 'share code' provided to the applicant by that service (please see note 15 for information)		

SECOND INDIVIDUAL APPLICANT (if applicable)

	Other Title (for example, Rev)	
Surname	First names	
Date of birth	I am 18 years old or over	

Nationality			
Where applicable (if demonstrating a right to work via the Home Office online right to work checking service), the 9-digit 'share code' provided to the applicant by that service: (please see note 15 for information)			
Current residential address if different from premises address			
Post town		Postcode	
Daytime contact telephone number			
E-mail address (optional)			

(B) OTHER APPLICANTS

Please provide name and registered address of applicant in full. Where appropriate please give any registered number. In the case of a partnership or other joint venture (other than a body corporate), please give the name and address of each party concerned.

Name
Address
Registered number (where applicable)
Description of applicant (for example, partnership, company, unincorporated association etc.)
Telephone number (if any)
E-mail address (optional)

Part 3 Operating Schedule

When do you want the premises licence to start?

10/06/2020

If you wish the licence to be valid only for a limited period, when do you want it to end?

Please give a general description of the premises (please read guidance note 1)
GROCERY SHOP

If 5,000 or more people are expected to attend the premises at any one time, please state the number expected to attend.

What licensable activities do you intend to carry on from the premises?
 (please see sections 1 and 14 and Schedules 1 and 2 to the Licensing Act 2003)

Provision of regulated entertainment (please read guidance note 2)

Please tick all that apply

- a) plays (if ticking yes, fill in box A)
- b) films (if ticking yes, fill in box B)
- c) indoor sporting events (if ticking yes, fill in box C)
- d) boxing or wrestling entertainment (if ticking yes, fill in box D)
- e) live music (if ticking yes, fill in box E)
- f) recorded music (if ticking yes, fill in box F)
- g) performances of dance (if ticking yes, fill in box G)
- h) anything of a similar description to that falling within (e), (f) or (g) (if ticking yes, fill in box H)

Provision of late night refreshment (if ticking yes, fill in box I)

Supply of alcohol (if ticking yes, fill in box J)

X

In all cases complete boxes K, L and M

A

Plays Standard days and timings (please read guidance note 7)	<u>Will the performance of a play take place indoors or outdoors or both – please tick</u> (please read guidance note 3)	Indoors	
		Outdoors	

Day	Start	Finish		Both
Mon			Please give further details here (please read guidance note 4)	
Tue				
Wed			State any seasonal variations for performing plays (please read guidance note 5)	
Thur				
Fri			Non standard timings. Where you intend to use the premises for the performance of plays at different times to those listed in the column on the left, please list (please read guidance note 6)	
Sat				
Sun				

B

Films Standard days and timings (please read guidance note 7)			Will the exhibition of films take place indoors or outdoors or both – please tick (please read guidance note 3)	Indoors	
Day	Start	Finish		Outdoors	
Mon			Please give further details here (please read guidance note 4)	Both	
Tue					
Wed			State any seasonal variations for the exhibition of films (please read guidance note 5)		
Thur					
Fri			Non standard timings. Where you intend to use the premises for the exhibition of films at different times to those listed in the column on the left, please list (please read guidance note 6)		
Sat					
Sun					

C

Indoor sporting events Standard days and timings (please read guidance note 7)			<u>Please give further details</u> (please read guidance note 4)
Day	Start	Finish	
Mon	-----	-----	<u>State any seasonal variations for indoor sporting events</u> (please read guidance note 5)
Tue	-----	-----	
Wed	-----	-----	
Thur	-----	-----	<u>Non standard timings. Where you intend to use the premises for indoor sporting events at different times to those listed in the column on the left, please list</u> (please read guidance note 6)
Fri	-----	-----	
Sat	-----	-----	
Sun	-----	-----	

D

Boxing or wrestling entertainments Standard days and timings (please read guidance note 7)			<u>Will the boxing or wrestling entertainment take place indoors or outdoors or both – please tick</u> (please read guidance note 3)	Indoors	
Day	Start	Finish		Outdoors	
Mon	-----	-----	Both		<u>Please give further details here</u> (please read guidance note 4)
Tue	-----	-----			
Wed	-----	-----			
Thur	-----	-----			<u>State any seasonal variations for boxing or wrestling entertainment</u> (please read guidance note 5)
Fri	-----	-----			
Sat	-----	-----			
Sun	-----	-----			
					<u>Non standard timings. Where you intend to use the premises for boxing or wrestling entertainment at different times to those listed in the column on the left, please list</u> (please read guidance note 6)
Fri	-----	-----			
Sat	-----	-----			
Sun	-----	-----			

E

Live music Standard days and timings (please read guidance note 7)			Will the performance of live music take place indoors or outdoors or both – please tick (please read guidance note 3)	Indoors		
Day	Start	Finish		Outdoors		
Mon	-----	-----		Please give further details here (please read guidance note 4)	Both	
Tue	-----	-----				
Wed	-----	-----	State any seasonal variations for the performance of live music (please read guidance note 5)			
Thur	-----	-----				
Fri	-----	-----	Non standard timings. Where you intend to use the premises for the performance of live music at different times to those listed in the column on the left, please list (please read guidance note 6)			
Sat	-----	-----				
Sun	-----	-----				

F

Recorded music Standard days and timings (please read guidance note 7)			Will the playing of recorded music take place indoors or outdoors or both – please tick (please read guidance note 3)	Indoors		
Day	Start	Finish		Outdoors		
Mon	-----	-----		Please give further details here (please read guidance note 4)	Both	
Tue	-----	-----				
Wed	-----	-----	State any seasonal variations for the playing of recorded music (please read guidance note 5)			
Thur	-----	-----				
Fri	-----	-----	Non standard timings. Where you intend to use the premises for the playing of recorded music at different times to those listed in the column on the left, please list (please read guidance note 6)			
Sat	-----	-----				
Sun	-----	-----				

G

Performances of dance Standard days and timings (please read guidance note 7)			<u>Will the performance of dance take place indoors or outdoors or both – please tick</u> (please read guidance note 3)	Indoors	
				Outdoors	
				Both	
Day	Start	Finish	<u>Please give further details here</u> (please read guidance note 4)		
Mon	-----	-----			
Tue	-----	-----			
Wed	-----	-----			
Thur	-----	-----			
Fri	-----	-----			
Sat	-----	-----			
Sun	-----	-----	<u>State any seasonal variations for the performance of dance</u> (please read guidance note 5)		
			<u>Non standard timings. Where you intend to use the premises for the performance of dance at different times to those listed in the column on the left, please list</u> (please read guidance note 6)		

H

Anything of a similar description to that falling within (e), (f) or (g) Standard days and timings (please read guidance note 7)			Please give a description of the type of entertainment you will be providing		
Day	Start	Finish	<u>Will this entertainment take place indoors or outdoors or both – please tick</u> (please read guidance note 3)	Indoors	
Mon	-----	-----		Outdoors	
				Both	
Tue	-----	-----	<u>Please give further details here</u> (please read guidance note 4)		
Wed	-----	-----			
Thur	-----	-----			
Fri	-----	-----	<u>State any seasonal variations for entertainment of a similar description to that falling within (e), (f) or (g)</u> (please read guidance note 5)		

Sat			<p>Non standard timings. Where you intend to use the premises for the entertainment of a similar description to that falling within (e), (f) or (g) at different times to those listed in the column on the left, please list (please read guidance note 6)</p>
Sun			

I

<p>Late night refreshment Standard days and timings (please read guidance note 7)</p>			<p>Will the provision of late night refreshment take place indoors or outdoors or both – please tick (please read guidance note 3)</p>	Indoors	
				Outdoors	
				Both	
Day	Start	Finish	<p>Please give further details here (please read guidance note 4)</p>		
Mon					
Tue					
Wed			<p>State any seasonal variations for the provision of late night refreshment (please read guidance note 5)</p>		
Thur					
Fri			<p>Non standard timings. Where you intend to use the premises for the provision of late night refreshment at different times, to those listed in the column on the left, please list (please read guidance note 6)</p>		
Sat					
Sun					

J

<p>Supply of alcohol Standard days and timings (please read guidance note 7)</p>			<p>Will the supply of alcohol be for consumption – please tick (please read guidance note 8)</p>	On the premises	
				Off the premises	X
				Both	
Day	Start	Finish	<p>State any seasonal variations for the supply of alcohol (please read guidance note 5)</p> <p>NO VARIATIONS</p>		
Mon	10:00	20:00			
Tue	10:00	20:00			
Wed	10:00	20:00			

Thur	10:00	20:00	<p>Non standard timings. Where you intend to use the premises for the supply of alcohol at different times to those listed in the column on the left, please list (please read guidance note 6)</p> <p>THE SHOP WILL ALWAYS BE CLOSED ON THE 25TH AND 26TH OF DECEMBER AND ALSO ON THE 1ST AND 2ND OF JANUARY</p>
Fri	10:00	20:00	
Sat	10:00	20:00	
Sun	10:00	16:00	

State the name and details of the individual whom you wish to specify on the licence as designated premises supervisor (Please see declaration about the entitlement to work in the checklist at the end of the form):

Name Mrs. MANUELA FERDES	
Date of birth 17/08/1987	
Address	
Postcode	
Personal licence number (if known) 501/1494/3	20/02344/LAPE01
Issuing licensing authority (if known)	Gravesham Borough Council

K

Please highlight any adult entertainment or services, activities, other entertainment or matters ancillary to the use of the premises that may give rise to concern in respect of children (please read guidance note 9).

L

Hours premises are open to the public Standard days and timings (please read guidance note 7)			State any seasonal variations (please read guidance note 5) NO VARIATIONS
Day	Start	Finish	
Mon	10:00	20:00	
	-----	-----	
Tue	10:00	20:00	
	-----	-----	
Wed	10:00	20:00	
	-----	-----	
Thur	10:00	20:00	Non standard timings. Where you intend the premises to be open to the public at different times from those listed in the column on the left, please list (please read guidance note 6) THE SHOP WILL ALWAYS BE CLOSED ON THE 25TH AND 26TH OF DECEMBER AND ALSO ON THE 1ST AND 2ND OF JANUARY
	-----	-----	
Fri	10:00	20:00	
	-----	-----	
Sat	10:00	20:00	
	-----	-----	
Sun	10:00	16:00	
	-----	-----	

M

Describe the steps you intend to take to promote the four licensing objectives:

a) General – all four licensing objectives (b, c, d and e) (please read guidance note 10)

BY THE INTENTIONS OF SELLING ALCOHOL IN MY PREMISE I INTEND TO APLY ANY MEASURES THAT I CAN IN ORDER TO PREVENT CRIME AND DISORDER, TO KEEP OUR CUSTOMER SAFE, THE CHILDREN AND THE PUBLIC. I HAVE INSTALLED CLEAR CCTV CAMERAS IN THE SHOP AND ALL OUR STAFF WILL BE FULLY TRAINED.

b) The prevention of crime and disorder

I UNDERSTAND THE IMPORTANCE OF PREVENT ANY KIND OF CRIME AND DISORDER. BY SELLING THE ALCOHOL IN THE PREMISE I UNDERSTAND THE IMPORTANCE OF HOW THE ALCOHOL COULD AFFECT SOME PEOPLE. I INTEND TO TRAIN ALL THE STAFF ABOUT IT AND ALSO TO HAVE CLEAR RULES AS TO WHO CAN BUY AND WHO CAN'T. THERE WILL BE NO EXEMPTION TO SELL TO ANYONE THAT IS UNDERAGE, DRUNK, THAT HAS ANY KIND OF VIOLENT BEHAVIOUR. CCTV CAMERAS ARE INSTALLED IN THE SHOP.

c) Public safety

THE SELLING OF ALCOHOL WILL TAKE PLACE IN THE SHOP BUT THE CUSTOMERS ARE NOT ALLOWED TO CONSUME IT INSIDE. THE STAFF ONCE AGAIN WILL BE TRAINED IN DOING SO. THE SHOP IS A GROCERY/OFF LICENCE KIND OF SHOP SO THERE IS NO DRINKING IN ANY PARTS OF THE PREMISE.

d) The prevention of public nuisance

IN ORDER NOT TO DISTURB THE PUBLIC WE INTEND TO SELL ALCOHOL BUT THE CUSTOMERS CANT CONSUME IT THE PREMISE. THE STAFF WILL BE TRAINED THAT THEY ARE NOT ALLOWED TO SELL ALCOHOL ANYTIME BUT ONLY DURING HOUR OPERATING HOURS. WE HAVE CLEAR CCTV CAMERAS INSTALLED. WE UNDERSTAND THAT IN ORDER TO AVOID DISTURBING THE CUSTOMERS OR ANY OF THE PUBLIC FROM THE OUTSIDE IS VERY IMPORTANT TO HAVE CLEAR RULES THAT EVERYONE NEED TO NOW AND APPLY.

e) The protection of children from harm

I KNOW HOW IMPORTANT IS TO KEEP THE CHILDREN SAFE AND I INTEND TO TRAIN ALL THE STAFF ABOUT THE IMPORTANCE OF IT. THERE WILL BE NO SELLING ALCOHOL TO ANYONE THAT DOESN'T RESEBLE THE AGE TO CONSUME IT AND DON'T PROVIDE AN ID TO PROVE THEIR AGE.

Checklist:

Please tick to indicate agreement

- I have made or enclosed payment of the fee.
- I have enclosed the plan of the premises.
- I have sent copies of this application and the plan to responsible authorities and others where applicable.
- I have enclosed the consent form completed by the individual I wish to be designated premises supervisor, if applicable.
- I understand that I must now advertise my application.
- I understand that if I do not comply with the above requirements my application will be rejected.
- [Applicable to all individual applicants, including those in a partnership which is not a limited liability partnership, but not companies or limited liability partnerships] I have included documents demonstrating my entitlement to work in the United Kingdom or my share code issued by the Home Office online right to work checking service (please read note 15).

IT IS AN OFFENCE, UNDER SECTION 158 OF THE LICENSING ACT 2003, TO MAKE A FALSE STATEMENT IN OR IN CONNECTION WITH THIS APPLICATION. THOSE WHO MAKE A FALSE STATEMENT MAY BE LIABLE ON SUMMARY CONVICTION TO A FINE OF ANY AMOUNT.

IT IS AN OFFENCE UNDER SECTION 24B OF THE IMMIGRATION ACT 1971 FOR A PERSON TO WORK WHEN THEY KNOW, OR HAVE REASONABLE CAUSE TO BELIEVE, THAT THEY ARE DISQUALIFIED FROM DOING SO BY REASON OF THEIR IMMIGRATION STATUS. THOSE WHO EMPLOY AN ADULT WITHOUT LEAVE OR WHO IS SUBJECT TO CONDITIONS AS TO EMPLOYMENT WILL BE LIABLE TO A CIVIL PENALTY UNDER SECTION 15 OF THE IMMIGRATION, ASYLUM AND NATIONALITY ACT 2006 AND PURSUANT TO SECTION 21 OF THE SAME ACT, WILL BE COMMITTING AN OFFENCE WHERE THEY DO SO IN THE KNOWLEDGE, OR WITH REASONABLE CAUSE TO BELIEVE, THAT THE EMPLOYEE IS

DISQUALIFIED.

Part 4 – Signatures (please read guidance note 11)**Signature of applicant or applicant’s solicitor or other duly authorised agent** (see guidance note 12). **If signing on behalf of the applicant, please state in what capacity.**

Declaration	<ul style="list-style-type: none"> [Applicable to individual applicants only, including those in a partnership which is not a limited liability partnership] I understand I am not entitled to be issued with a licence if I do not have the entitlement to live and work in the UK (or if I am subject to a condition preventing me from doing work relating to the carrying on of a licensable activity) and that my licence will become invalid if I cease to be entitled to live and work in the UK (please read guidance note 15). The DPS named in this application form is entitled to work in the UK (and is not subject to conditions preventing him or her from doing work relating to a licensable activity) and I have seen a copy of his or her proof of entitlement to work, or have conducted an online right to work check using the Home Office online right to work checking service which confirmed their right to work (please see note 15)
Signature	ALEXANDRU SAVESCU
Date	2020-05-11
Capacity	Applicant

For joint applications, signature of 2nd applicant or 2nd applicant’s solicitor or other authorised agent (please read guidance note 13). **If signing on behalf of the applicant, please state in what capacity.**

Signature			
Date			
Capacity			
Contact name (where not previously given) and postal address for correspondence associated with this application (please read guidance note 14)			
60-61 new road GRAVESEND KENT DA11 0AD			
Post town	GRAVESEND	Postcode	DA11 0AD
Telephone number (if any)	/		
If you would prefer us to correspond with you by e-mail, your e-mail address (optional)			

This page is intentionally left blank

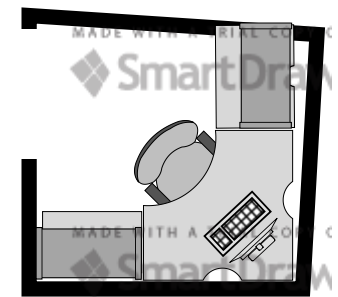
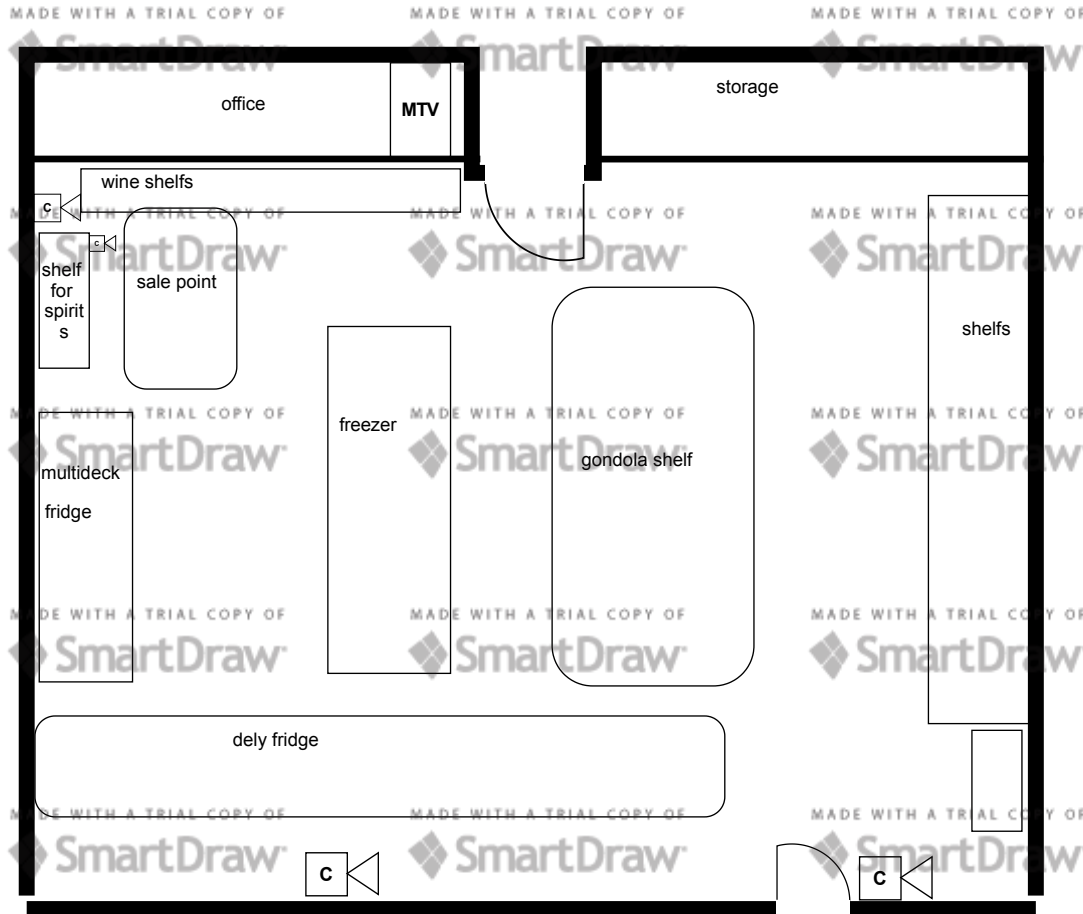

This page is intentionally left blank

13 OCT 2020

10TH October 2020

Dear Sir/Madam,

Ref: Mr Alexander Savescu 60-61 New Road Gravesend, Kent, DA11 0AD notice of application for a grant of premise licence

I am writing to make a representation to the above application for the grant of a new premises licence.

The representation is related to the prevention of public safety.

We have had a family run business on Darnley Road for more than 20 years and were one of the first shops in the area to have a license. We have seen recently this number increase steadily over the years. Along with this we have seen the problems related to drinking increase also.

We feel that there is already too many off licences in the area, we have counted more than 10 within a 1-mile radius from our shop including Tesco, Asda, B&M, Icelands, Lithuanca, Central News, Punjabi Meat Market, T S Das and Sons, Royals, MD Wine, East West Stores and Savers Store.

We feel due to the current pandemic we are in; business is more difficult to carry out in an overcrowded market place. This leads to competitive pricing allowing customers to purchase alcohol at the lower rate, which can also lead to street drinking and anti-social behaviour issues.

When there is any drinking related problems in the area, this is soon followed by a visit by the local police or PCO to request CCTV.

Only recently we have had police visit the store in regards to drinking issues going on in the area and how new regulations are being brought in to make this whole Town Centre a non-drinking zone. We therefore feel that this doesn't justify giving another business an Off Licence.

We hope this letter is put forward for consideration and if you require any other details please do contact us.

Kind regards