

LICENSING ACT 2003 Premises Licence

Premises licence number: 18/00657/LAPL04

Part 1 - Premises details

Postal address of premises, or if none, ordnance survey map reference or description	
The Cricketers, 47 Arthur Street	
Post town: Gravesend	Post code: DA11 0PR
Telephone number: 01474 32 73 01	

Licensable activities authorised by the licence

Sale by retail of alcohol and recorded music

The times the licence authorises the carrying out of licensable activities

Recorded music and sale of alcohol

Monday to Friday 13:00 to 00:00

Saturday 11:00 to 00:00

Sunday Noon to 00:00

Good Friday 12:00 to 22.30

Christmas Day, 12:00 to 15:00 and 19:00 to 22:30

New Year's Eve from the end of permitted hours on New Year's Eve to the start of permitted hours on the following day (or, if there are no permitted hours on the following day, midnight on 31st December).

The above restrictions do not prohibit:

- (a) during the first twenty minutes after the above hours the consumption of the alcohol on the premises;
- (b) during the first twenty minutes after the above hours, the taking of the alcohol from the premises unless the alcohol is supplied or taken in an open vessel;
- (c) during the first thirty minutes after the above hours the consumption of the alcohol on the premises by persons taking meals there if the alcohol was supplied for consumption as ancillary to the meals;
- (d) consumption of the alcohol on the premises or the taking of sale or supply of alcohol to any person residing in the licensed premises;
- (e) the ordering of alcohol to be consumed off the premises, or the despatch by the vendor of the alcohol so ordered;
- (f) the sale of alcohol to a trader or club for the purposes of the trade or club;
- (g) the sale or supply of alcohol to any canteen or mess, being a canteen in which the sale or supply of alcohol is carried out under the authority of the Secretary of State or an authorised mess of members of Her Majesty's naval, military or air forces;
- (h) the taking of alcohol from the premises by a person residing there; or
- (i) the supply of alcohol for consumption on the premises to any private friends of a person residing there who are bona fide entertained by him at his own expense, or the consumption of alcohol by persons so supplied; or
- (j) the supply of alcohol for consumption on the premises to persons employed there for the purposes of the business carried on by the holder of the licence, or the consumption of liquor so supplied, if the liquor is supplied at the expense of their employer or of the person carrying on or in charge of the business on the premises.



No person under fourteen shall be in the bar of the licensed premises during the permitted hours unless one of the following applies:

- (1) He is the child of the holder of the premises licence.
- (2) He resides in the premises, but is not employed there.
- (3) He is in the bar solely for the purpose of passing to or from some part of the premises which is not a bar and to or from which there is no other convenient means of access or egress.
- (4) The bar is in railway refreshment rooms or other premises constructed, fitted and intended to be used bona fide for any purpose to which the holding of the licence is ancillary.

In this condition "bar" includes any place exclusively or mainly used for the consumption of intoxicating liquor. But an area is not a bar when it is usual for it to be, and it is, set apart for the service of table meals and alcohol is only sold or supplied to persons as an ancillary to their table meals.

The opening hours of the premises

Monday to Friday 13:00 to 00:00
 Saturday 11:00 to 00:00
 Sunday Noon to 00:00

Where the licence authorises supplies of alcohol whether these are on and/ or off supplies

On and off

Part 2

Name, (registered) address, telephone number and email (where relevant) of holder of premises licence

Mr Mandeep Ricky Manik
 The Cricketers, 47 Arthur Street, Gravesend, Kent DA11 0PR

Name, address and telephone number of designated premises supervisor where the premises licence authorises for the supply of alcohol

Mr Mandeep Ricky Manik

Personal licence number and issuing authority of personal licence held by designated premises supervisor where the premises licence authorises for the supply of alcohol

Mandatory conditions

Condition 1 – took effect 24 November 2005

No supply of alcohol may be made under this licence:-

- (a) At a time when there is no designated premises supervisor in respect of it or
- (b) At a time when the designated premises supervisor does not hold a personal licence or his/her personal licence is suspended.

Every retail sale or supply of alcohol made under this licence must be made or authorised by a person who holds a personal licence.

Condition 7 – took effect 1 October 2014

- (1) The responsible person must ensure that staff on relevant premises do not carry out, arrange or participate in any irresponsible promotions in relation to the premises.**
- (2) In this paragraph, an irresponsible promotion means any one or more of the following activities, or substantially similar activities, carried on for the purpose of encouraging the sale of supply of alcohol for consumption on the premises**
 - (a) Games or other activities which require or encourage, or are designed to require or encourage, individuals to**
 - (i) Drink a quantity of alcohol within a time limit (other than to drink alcohol sold or supplied on the premises before the cessation of the period in which the responsible person is authorised to sell or supply alcohol) or**
 - (ii) Drink as much alcohol as possible (whether within a time limit or otherwise)**
 - (b) Provision of unlimited or unspecified quantities of alcohol free or for a fixed or discounted fee to the public or to a group defined by a particular characteristic in a manner which carries a significant risk of undermining a licensing objective;**
 - (c) Provision of free or discounted alcohol or any other thing as a prize to encourage or reward the purchase and consumption of alcohol over a period of 24 hours or less in a manner which carries significant risk of undermining a licensing objective;**
 - (d) Selling or supplying alcohol in association with promotional posters or flyers on, or in the vicinity of, the premises which can reasonably be considered to condone, encourage or glamorise anti-social behaviour or to refer to the effects of drunkenness in any favourable manner;**
 - (e) Dispensing alcohol directly by one person into the mouth of another (other than where that other person is unable to drink without assistance by reason of disability).**

Condition 8 – took effect 1 October 2014

The responsible person must ensure that free potable water is provided on request to customers where it reasonably available.

Condition 9 – took effect 1 October 2014

- (1) The premises licence holder or club premises certificate holder must ensure that an age verification policy is adopted in respect of the premises in relation to the sale or supply of alcohol**
- (2) The designated premises supervisor in relation to the premises licence must ensure that the supply of alcohol at the premises is carried on in accordance with the age verification policy.**
- (3) The policy must require individuals who appear to the responsible person to be under 18 years of age (or such older age as may be specified in the policy) to produce on request, before being served alcohol, identification bearing their photograph, date of birth and either**

- (a) a holographic mark, or
- (b) an ultraviolet feature

Condition 10 – took effect 1 October 2014

The responsible person must ensure that:-

- (a) Where any of the following alcoholic drinks is sold or supplied for consumption on the premises (other than alcoholic drinks sold or supplied having been made up in advance ready for sale or supply in a securely closed container) it is available to customers in the following measures:-
 - (i) beer or cider: ½ pint;
 - (ii) gin, rum, vodka or whisky: 25ml or 35 ml; and
 - (iii) still wine in a glass: 125ml; and
- (b) These measures are displayed in a menu, price list or other printed material which is available to customers on the premises; and
- (c) Where a customer does not in relation to a sale of alcohol specify the quantity of alcohol to be sold, the customer is made aware that these measures are available.

Condition 11 – took effect 28 May 2014

- (1) A relevant person shall ensure that no alcohol is sold or supplied for consumption on or off the premises for a price, which is less than the permitted price.
- (2) For the purpose of the condition set out in paragraph 1:-
 - (a) “duty” is to be construed in accordance with the Alcoholic Liquor Duties Act 1979(6);
 - (b) “permitted price” is the price found by applying the formula:- $P = D + (D \times V)$ where:-
 - (i) P is the permitted price,
 - (ii) D is the amount of duty chargeable in relation to the alcohol as if the duty were charged on the date of the sale or supply of the alcohol, and
 - (iii) V is the rate of value added tax chargeable in relation to the alcohol as if the value added tax were charged on the date of the sale or supply of the alcohol;
 - (c) “relevant person” means, in relation to premises in respect of which there is in force a premises licence:-
 - (i) the holder of the premises licence
 - (ii) the designated premises supervisor (if any) in respect of such a licence, or
 - (iii) the personal licence holder who makes or authorises a supply of alcohol under such a licence;
 - (d) “relevant person” means, in relation to premises in respect of which there is in force a club premises certificate, any member or officer of the club present on the premises in a capacity which enables the member or officer to prevent the supply in question; and
 - (e) “value added tax” means value added tax charged in accordance with the Value Added Tax Act 1994(7)



- (3) Where the permitted price given by Paragraph (b) of paragraph (2) would (apart from this paragraph) not be a whole number of pennies, the price given by that sub-paragraph shall be taken to be the price actually given by that sub-paragraph rounded up to the nearest penny.
- (4) (1) Sub-paragraph (2) applies where the permitted price given by Paragraph (b) of paragraph (2) on a day (“the first day”) would be different from the permitted price on the next day (“the second day”) as a result of a change to the rate of duty or value added tax.
- (2) The permitted price which would apply on the first day applies to sales or supplies of alcohol which take place before the expiry of the period of 14 days beginning on the second day.

Conditions consistent with the operating schedule

There will be no admittance to the premises by members of the public after 23:00.

Prominent, clear and legible notices will be displayed at the exits asking customers to respect the needs of local residents and to leave the premises and the area quietly.

Children will not be permitted on the premises after 21.00. When children are on the premises they must be accompanied by a responsible adult.

Signed:

A handwritten signature in black ink, appearing to read 'Mark Lees'.

Mark Lees HND MSc AMIOA MCIEH
Regulatory Services Manager

Dated: 07 August 2018

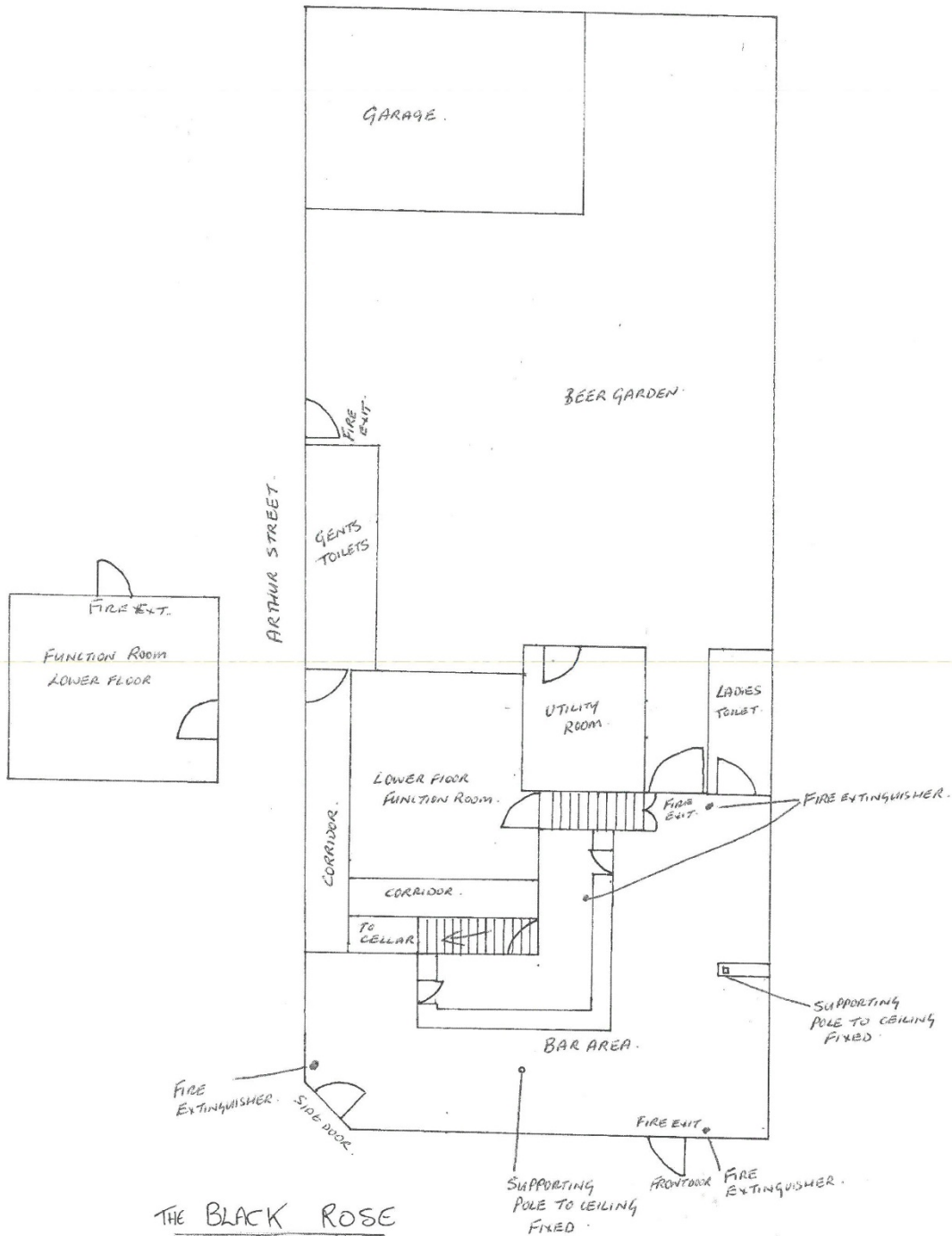

THE BLACK ROSE
27 ARTHUR STREET
GRAVESEND
RENT DA11 0PR.
01474 327301.

SCALE 1:75